

4MP Dual-lens Network Camera

TVT-TD-9844E3B



Arrowhead
Alarm Products



Applications:

A dual-lens camera is ideal for monitoring wide areas or two directions where separate cameras would typically be required. With only a single cable run, it provides two independent views, enabling enhanced coverage around corners or down corridors with improved detail and efficiency.

Features

- H.265+/H.265/H.264+/H.264/MJPEG coding
- Max. resolution: 2688 × 1520
- ICR auto switch, true day / night vision
- 20 ~ 30m IR night view distance
- 3D DNR, WDR, HLC, BLC, Defog, Smart IR and ROI coding
- Support image distortion correction
- Support 2-split screen preview
- Built-in micro SD card slot, up to 512GB
- DC12V/PoE power supply
- IP 66 & IK 10 ingress protection
- Support P2P function



Trade Only
Proudly Supporting NZ Installers



SPECIFICATIONS

Model	TVT-TD-9844E3B			
Specifications				
Camera				
Image Sensor	1 / 3 "CMOS*2			
Image Size	2688 × 1520			
Electronic Shutter	1 / 3 s ~ 1 / 100000 s			
Iris Type	Fixed Iris			
Min. Illumination	0.005 lux@F1.6,AGC ON;0 lux with IR			
Lens	2.8 mm@F1.6, Horizontal FoV: 101°; vertical FoV: 55°; diagonal FoV:122° 3.6 mm@F1.6, Horizontal FoV: 83°; vertical FoV: 42°; diagonal FoV:100°			
Focus	Fixed			
Lens Mount	M12			
Day & Night	ICR			
Wide Dynamic Range	120dB			
BLC	Yes			
HLC	Yes			
Defog	Yes			
S/N Ratio	≥50dB			
Digital NR	3D DNR			
Angle Adjustment	Pan: -90°~90°; Tilt:0°~65°; Rotation: 0°~355°			
Image				
Video Compression	Main/Third stream: H.265+ / H.265 / H.264+ / H.264 Sub stream: H.265+ / H.265 / H.264+ / H.264 / MJPEG			
H.264 Compression Standard	Baseline Profile/Main Profile/High Profile			
Resolution	4MP (2688×1520), 2K (2560×1440), 3MP(2304×1296), 1080P (1920×1080), 720P (1280×720), D1, VGA(640×480), 640×360, CIF, 480 × 240			
Main Stream	4MP/2K/3MP/1080P (60Hz : 1 ~ 30fps; 50Hz: 1~25fps)			
Sub Stream	720P/D1/VGA/640×360/480×240/CIF(60Hz : 1 ~ 30fps; 50Hz: 1~25fps)			
Third Stream	D1/CIF/480×240 (60Hz : 1 ~ 30fps; 50Hz: 1~25fps)			
Bit Rate	64 Kbps ~ 8 Mbps			
Bit Rate Type	VBR / CBR			
Audio Compression	G711A / U			
Image Settings	ROI, Saturation, Brightness, Hue, Contrast, Wide Dynamic, Sharpness, Image Mirror, Image Flip, NR, etc. adjustable through client software or web browser			
ROI	Each ROI to be configured separately			
Intelligent Analytics				
Smart Event	Line crossing, region intrusion/entrance/exiting (human/vehicle classification) loitering detection, illegal parking detection, abandoned/ missing object detection			
Statistics	Target counting by line/area, heat map			
Exception Detection	Scene change, video blur and abnormal color detection, audio exception			
Face Detection	Face detection and face capture			
DORI Distance				
Lens	Detect	Observe	Recognize	Identify
2.8mm	58m(191ft)	23m(76ft)	12m(38ft)	6m(19ft)
3.6mm	79m(260ft)	32m(104ft)	16m(52ft)	8m(26ft)
Interfaces				
Network	RJ 45 10M/100M self-adaptive Ethernet port			
Video Output	No			
Audio	1CH audio input; 1CH audio output; 2CH built-in MICs; 1CH built-in speaker			
Storage	Built-in micro SD card slot; up to 512GB			
Reset	Yes			
Alarm	2CH alarm input; 2CH alarm output			
Power Output	Yes, max. DC12V@100mA			
Functions				
Remote Monitoring	Web Browser/TVT NVMS2.0/NVR/mobile APP			
Web Browser	Chrome 89.0+/Edge 89.0+/Firefox 87.0+/Safari 14.0+			
Online Connection	Support simultaneous monitoring for up to 10 users; Support multi-stream real time transmission			

Network Protocol	UDP, IPv4, IPv6, DHCP, NTP, RTSP, RTP, RTMP, RTCP, PPPoE, DDNS, SMTP, FTP, SNMP, HTTP, HTTP POST, 802.1x, UPnP, HTTPS, P2P, QoS
Interface Protocol	ONVIF
Storage	Network remote storage; micro SD card storage
Smart Alarm	Motion detection, SMD, SD card error, SD card full, IP address conflict, network disconnection, audio alarm
General Function	Watermark, video mask, heartbeat, image distortion correction, corridor pattern, disarming, ANR, cloud upgrade
Security	Video encryption, firmware encryption, HTTPS encryption, configuration encryption, illegal login lock, IP address filtering, 802.1x authentication, basic and digest authentication for HTTP/RTSP/API services
PoE	Yes, IEEE802.3af
IR Distance	20~30 m
Ingress Protection	IP 66& IK10
Others	
Power Supply	DC12V/PoE
Power Consumption	<9.5W
Storage Conditions	-30 °C ~ 65 °C (-22 °F ~ 149 °F), Humidity: less than 95 % (non-condensing)
Operating Conditions	-30 °C ~ 60 °C (-22 °F ~ 140 °F), Humidity: less than 95 % (non-condensing)
Dimensions (mm)	165.4 × 97.4 × 72
Weight (net)	Approx. 0.755KG
Installation	Ceiling mounting; Wall mounting
Certificate	CE, FCC
Environmental Protection	Directive EU RoHS, WEEE(2012/19/EU), directive 94/62/EC and REACH(EC1907/2006)

Dimensions

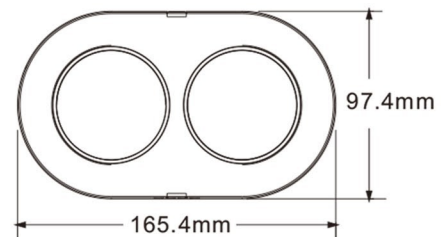
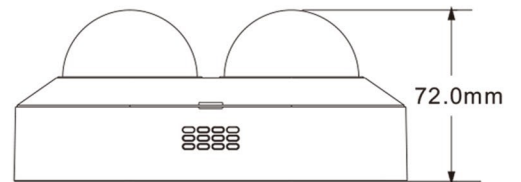

Lens 1

Lens 2