

Smart AI Network Camera

TVT-D2.8POE-B-AI

5MP IP Dome Camera with 2.8mm Fixed Lens



Arrowhead
Alarm Products



Features:

- 20 ~ 30m IR Range
- IP67 Outdoor Ready
- Max Resolution: 5MP (2880 x 1620)
- Smartphone app for iOS & Android
- Intelligent Analytics
- ICR auto switch, true day / night vision
- 3D DNR, WDR, HLC, BLC, smart IR
- ROI coding
- Built-in micro SD card slot (up to 256GB)
- DC12V POE power supply
- Supports three streams
- H.265+/H.265/H.264+/H.264/MJPEG coding

SPECIFICATIONS

Specifications	Model	TD-9554S4		
Camera				
Image Sensor		1 / 2.7 "CMOS		
Image Size		2880×1620		
Electronic Shutter		1 / 1s ~ 1 / 10000s		
Iris Type		Fixed Iris		
Min. Illumination		0.007 lux @F1.6, AGC ON; 0 lux with IR		
Lens		2.8mm@F1.6, Horizontal FoV:110.5°;Vertical FoV:57°; Diagonal FoV:131°		
Focus		Fixed		
Lens Mount		M12		
Day&Night		ICR		
Wide Dynamic Range		120dB		
BLC		Yes		
HLC		Yes		
Digital NR		Yes		
Angle Adjustment		Pan: 0°~360°; Tilt:0°~90°;Rotation: 0°~360°		
Image				
Video Compression		Main stream: H.265+ / H.265 / H.264+ / H.264 Sub stream: H.265+ / H.265 / H.264+ / H.264 / MJPEG Third stream: H.265+ / H.265 / H.264+ / H.264/ MJPEG		
H.265 Compression Standard		Main Profile@Leve4.1 High Tier		
Resolution		5MP (2880 × 1620), 4MP (2560 × 1440), 3MP (2304 × 1296), 1080P (1920 × 1080), 720P (1280 × 720), D1, 480× 240, CIF		
Main Stream		60Hz: 5MP(1~20fps)/4MP/3MP/1080P/720P(1~30fps); 50Hz: 5MP(1~20fps)/4MP/3MP/1080P/720P(1~25fps)		
Sub Stream		60Hz: 720P/D1/CIF (1~30fps);50Hz: 720P/D1/CIF (1~25fps)		
Third Stream		60Hz: D1/480× 240/CIF (1~30fps);50Hz: D1/480× 240/CIF(1~25fps)		
Bit Rate		64 Kbps ~ 8 Mbps		
Bit Rate Type		VBR / CBR		
Image Settings		ROI, Saturation, Brightness, Hue, Contrast, Wide Dynamic, Sharpness, Image Mirror, Image Flip, NR, etc. adjustable through client software or web browser		
ROI		Each ROI to be configured separately		
Functions				
Remote Monitoring		Web browser /TVT NVR/NVMS2.X/Mobile APP		
Web Browser		IE (plug-in required)/Google Chrome/Edge/Firefox/Safari		
Online Connection		Support simultaneous monitoring for up to 10 users; Support multi-stream real time transmission		
Network Protocol		UDP, IPv4, IPv6, DHCP, NTP, RTSP, RTP, RTCP, PPPoE, DDNS, SMTP, FTP, 802.1x, SNMP, UPnP, RTMP, HTTP, HTTPS, QoS		
Interface Protocol		ONVIF		
Storage		Network remote storage; micro SD card storage		
Smart Alarm		Motion detection, SD card full, SD card error		
Smart Event		Video Exception (scene change, video blur and video cast detection), line crossing detection, region intrusion detection, abandoned/missing object detection		
General Function		Watermark, IP address filtering, video mask, heartbeat, illegal login lock, corridor pattern		
PoE		Yes		
IR Distance		20 ~ 30 m		
Ingress Protection		IP67		
DORI Distance				
Lens	Detect	Observe	Recognize	Identify
2.8mm	59.67m(195.76ft)	23.87m(78.31ft)	11.93m(39.14ft)	5.97m(19.58ft)
3.6mm	71.10m(233.26ft)	28.44m(93.30ft)	14.22m(46.65ft)	7.11m(23.32ft)
6mm	97.97m(321.42ft)	39.19m(128.57ft)	19.59m(62.27ft)	9.80m(32.15ft)
Interfaces				
Network		RJ45		

Video Output	No
Audio	1CH audio input; 1CH built-in MIC
Storage	Built-in micro SD card slot, up to 256GB
Reset	Yes
Others	
Power Supply	DC12V/PoE
Power Consumption	< 5.5W
Operating Environment	- 30 °C ~ 60 °C (-22°F~140°F);Humidity: less than 95 % (non-condensing)
Storage Environment	- 30 °C ~ 65°C (-22°F~149°F), Humidity: less than 95 % (non-condensing)
Dimensions (mm)	Ø 95.7 × 108
Weight (net)	Approx. 0.46KG
Installation	Ceiling mounting(Wall mounting available with the junction box and bracket)
Certificate	CE, FCC
Environmental Protection	Complies with Directive EU RoHS, WEEE(2012/19/EU) , directive 94/62/EC and REACH(EC1907/2006)

DIMENSIONS

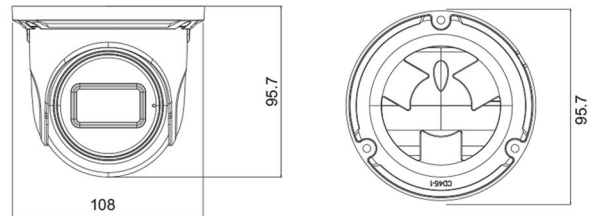

AVAILABLE ACCESSORIES



SuperCam Plus

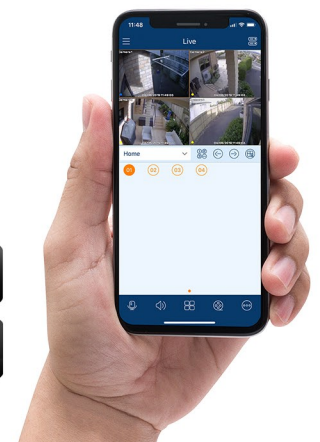

Plug & Play CCTV