

Curtain PIR Detector

OPT-AP-20NB(C)

Recessed low profile with multiple mounting options



Arrowhead
Alarm Products



Features

- Compact & discrete design
- Selectable detection sensitivity (low, medium & high)
- Tamper function
- Mounting options (ceiling or wall mount)
- Multiple detection pattern options

*Important note: this detector is **not** pet friendly*

Specifications

OPT-AP-20NB(C)



Arrowhead
Alarm Products

Specifications

Passive infrared
< Ceiling mount > 6.0 m x 1.0 m (20' x 3'3") at 4.5 m (14'9") height
2.5 m to 4.5 m (8'2" to 14'9")
Recessed ceiling mount/ Wall mount/ 86-type box mount
2.0°C at 0.6 m/s (3.6°F at 2'/s)
0.3 to 3.0 m/s (1'/s to 9'10"/s)
Warm-up upon power on: blinking Stand-by: off Alarm: solid on
Approx. 2 s
-
-
N.O./N.C., 28 V DC 200 mA max.
N.C. 28 V DC 100 mA max. The contact opens once the casing is detached.
Approx. 60 s
9.5 to 16 V DC
12 V DC Stand-by: 11mA, Max.: 13 mA
H/ M/ L
50 g (1.76 oz)
-20 to +50°C (-4°F to +122°F)
< 95%
Indoors
ø52 x 35.5 mm (ø2.05 in. x 1.40 in.): without switch box mount
86 x 86 x 36.5 mm (3.39 x 3.39 x 1.44 in.): with 86-type box mount

Mounting Options

Recessed Mount

The detector can be installed with recessed mount on the walls / ceiling.

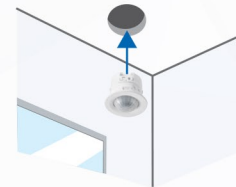

Recessed Mount with 86-type box

86-type box mount is available by using the included decorative plate.

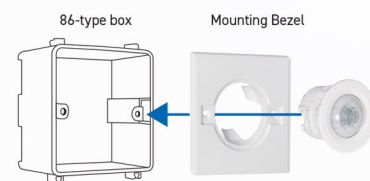

Detection Areas

AP-20NB/20NBR

[Ceiling Mount]

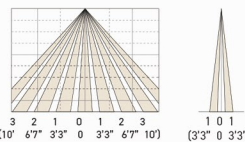

- Wall mount : Lower than 1.5 m (4.9 ft.) height
(AP-20NB/20NBR only)

- Ceiling mount : 2.5 to 4.5 m (8.2 to 14.8 ft.) height

[Wall Mount]

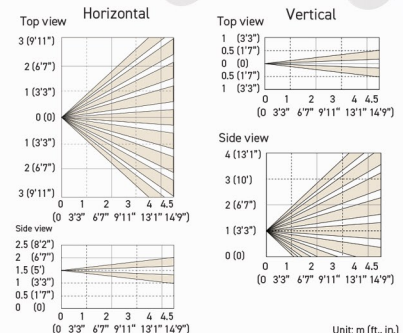

Unit: m (ft., in.)

Dimensions

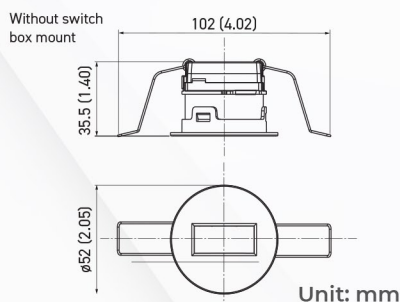

Spot Detection Pattern

[Ceiling Mount]

Curtain detection area

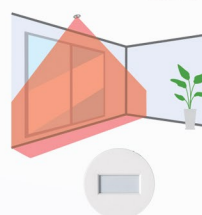

[Lens Direction : Vertical]

[Wall Mount]

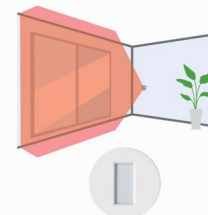

[Lens Direction : Horizontal]

Plane detection area

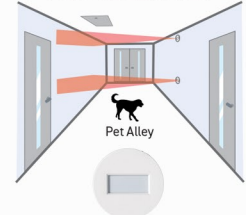

[Lens Direction : Vertical]