



AES

Advanced Electronic Solutions



Innovative **wireless** intercom solutions



2013
 **IFSEC & FIREX**
AWARDS

Finalist!



Predator

GSM Video Intercom



Modern back lighting



GSM-3V/AB



GSM-3V/ABK
(code lock version)



- No wires from your gate to house.
- Get a video call from your intercom from anywhere in the world.
- Works with most smartphones except Iphone.
- NEVER miss a call. ALWAYS seem at home!
- Easy programming by SMS text message.
- Open gates from your phone.
- 12v d.c. power supply adaptor included.
- 2 relay outputs.



Entrée Phone 603

Wireless D.E.C.T Intercom



- ✓ Wireless range 150 meters through 1 wall, or 250-350 meters through glass.
- ✓ Interference free - Digital DECT.
- ✓ Gate / Door release relay built in.
- ✓ Portable handset with charging base.
- ✓ Power adaptors included (12v dc for door / gate station & 5v d.c. for handset charger).

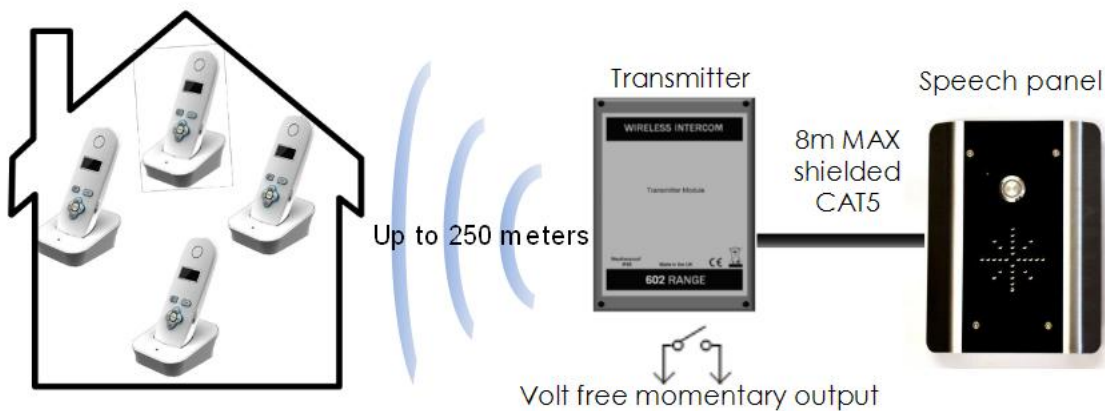



Architectural model

- Curved modern profile.
- Blue back lighting illumination from behind the curved sides.
- Illuminated push button and keypad.
- Surface mount.
- Stainless steel construction.
- Stylish gloss black acrylic trimmed face.
- IP55 weather proof design.

603-AB Standard model

603-ABK Keypad model



Hooded model

- Traditional hooded style.
- Illuminated push button and keypad.
- Surface mount.
- Stainless steel construction.
- Stylish gloss black acrylic trimmed face.
- IP55 weather proof design.

603-HB Standard model

603-HBK Keypad model



Industrial model

- High volume pedestal mount design for noisy areas.
- Hooded design in landscape style.
- Illuminated push button and keypad.
- Surface mount and pedestal mountable.
- Stainless steel construction with lockable front door.
- Stylish gloss black acrylic trimmed face.
- IP55 weather proof design.

603-iB Standard model

603-iBK Keypad model



Flush model

- Flush fitting for a sleek look.
- All stainless steel construction.
- Illuminated push button.
- Stylish gloss black acrylic trimmed front plate.

603-FB Standard model

603-FBK Keypad model



Additional Handsets

- Add up to 3 additional handsets for larger properties.
- Max total handsets per system = 4.
- Complete with charging base, charger, and rechargeable batteries.

603-EH



CELL COM 3AB Range

GSM Intercom Unlimited Range



- ✓ Unlimited range using GSM cellular networks.
- ✓ Speak to visitor with your home phone and/or mobile cell phone (dialling 3 numbers).
- ✓ Gate / Door release relay built in.
- ✓ Caller ID function, stores 100 numbers, which can call intercom to activate relay with no call charge.
- ✓ 12v d.c. Power adaptor included.
- ✓ Android app available for latching, unlatching & advanced control of gates.

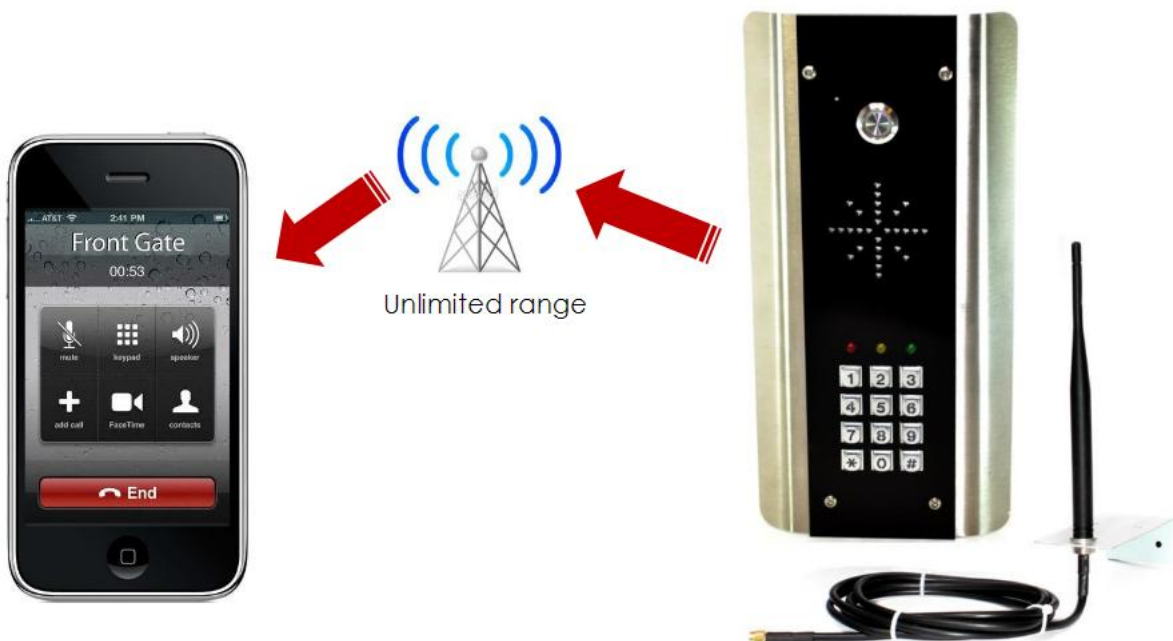



Architectural model

- Curved modern profile.
- Blue back lighting illumination from behind the curved sides.
- Illuminated push button and keypad.
- Surface mount.
- Stainless steel construction.
- Stylish gloss black acrylic trimmed face.
- IP55 weather proof design.

GSM-3AB Standard model **GSM-3ABK** Keypad model



Hooded model

- Traditional hooded style.
- Illuminated push button and keypad.
- Surface mount.
- Stainless steel construction.
- Stylish gloss black acrylic trimmed face.
- IP55 weather proof design.

GSM-3HB Standard model **GSM-3HBK** Keypad model



Industrial model

- High volume pedestal mount design for noisy areas.
- Hooded design in landscape style.
- Illuminated push button and keypad.
- Surface mount and pedestal mountable.
- Stainless steel construction with lockable front door.
- Stylish gloss black acrylic trimmed face.
- IP55 weather proof design.

GSM-3iB Standard model **GSM-3iBK** Keypad model



Flush model

- Flush fitting for a sleek look.
- All stainless steel construction.
- Illuminated push button.
- Stylish gloss black acrylic trimmed front plate.

GSM-3FB Standard model **GSM-3FBK** Keypad model



Android App GSM-GATE

- Available from Google Play store.
- Allows latching, unlatching control of most gate systems.
- Check gate status (opened or closed).
- Check intercom reception.
- Check stored numbers.

GSM-GATE

Entrée Phone 702 Range

Wireless Multi Button Intercom



- Wireless intercom system for gates or door.
- Standard kit range – 300m open field / 150m working range.
- High gain kit range – 550m open field / 350 working range.
- Up to 3 button panel available, with up to 3 handsets per button (9 handsets in total).
- Modern stylish portable handset, with back lit keys and LCD screen.
- Gate / Door release relay built in.



Wireless Digital Signal



Up to 350 meters!!

Optional range boosting directional antenna



Screened CAT5 (8 meters max)



- 702-AB1 – 1 button kit, 1 handset
- 702-AB2 – 2 button kit , 2 handsets
- 702-AB3 – 3 button kit, 3 handsets

- 702-ABK1 – 1 button kit + code lock, 1 handset
- 702-ABK2 – 2 button kit + code lock , 2 handsets
- 702-ABK3 – 3 button kit + code lock, 3 handsets

702-EH – Extra wireless handset (max total 3 per button)

702-LR – Long range antenna

CELL COM 800 Range

GSM Multi Button Intercom



- GSM intercom using mobile cell phone networks, 850/900/1800/1900 MHz bands.
- No range limit.
- Rings up to 3 telephone numbers (land lines and/or mobiles) in sequence when call button pressed.
- Gate / Door release relay built in, simply press the star key to open!
- Access control for up to 100 numbers using caller ID, at no call cost to users (ring intercom to open gate or door).

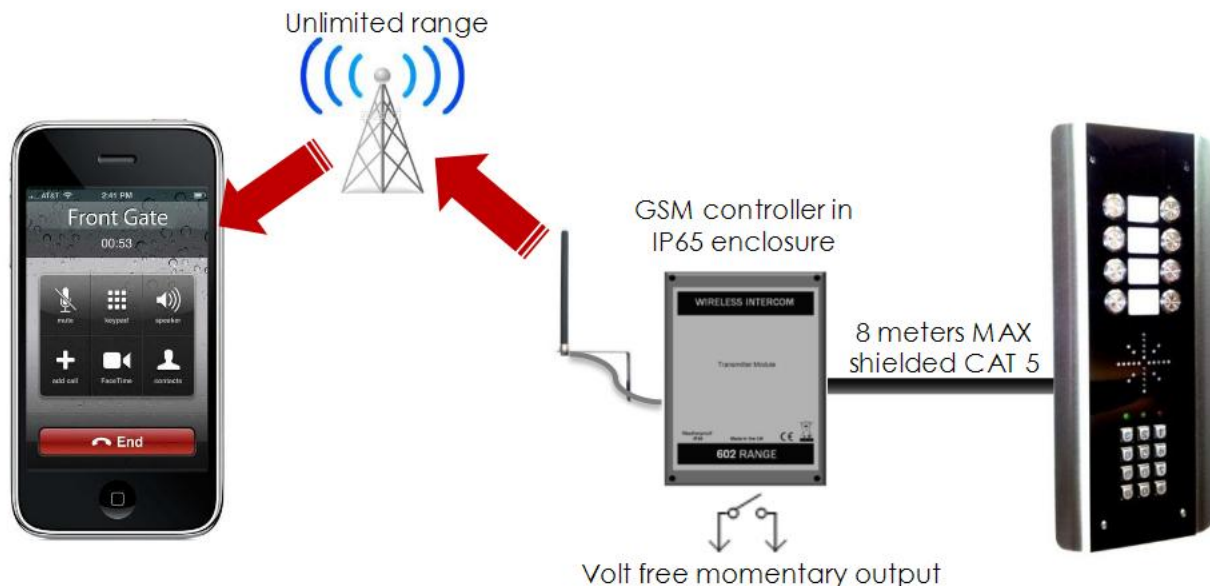

Non code lock model

- GSM-800AB2 – 2 button kit
- GSM-800AB4 – 4 button kit
- GSM-800AB6 – 6 button kit
- GSM-800AB8 – 8 button kit

Code lock model

- GSM-800ABK2 – 2 button kit
- GSM-800ABK4 – 4 button kit
- GSM-800ABK6 – 6 button kit
- GSM-800ABK8 – 8 button kit



Entrée Phone 605

Wireless DECT Video Intercom



- Digital Video intercom system.
- Class leading range of 300m line of sight (150 through 1 wall) / 450m line of sight (250 through 1 wall) using range booster antenna.
- Heavy gauge 2mm brushed stainless steel speech panel.
- Modern gloss black insert, and neon blue backlighting.
- Portable stylish handset and charging base.
- Door release relay built in.



605AB

Standard model kit.

605ABK

Keypad model kit.

605ADA

Range boosting antenna for audio signal.

603-EH

Add on up to 3 additional audio handsets

605-AC5

5m extension. Requires 2 to extend antenna position.



Power-Com

Video over Mains

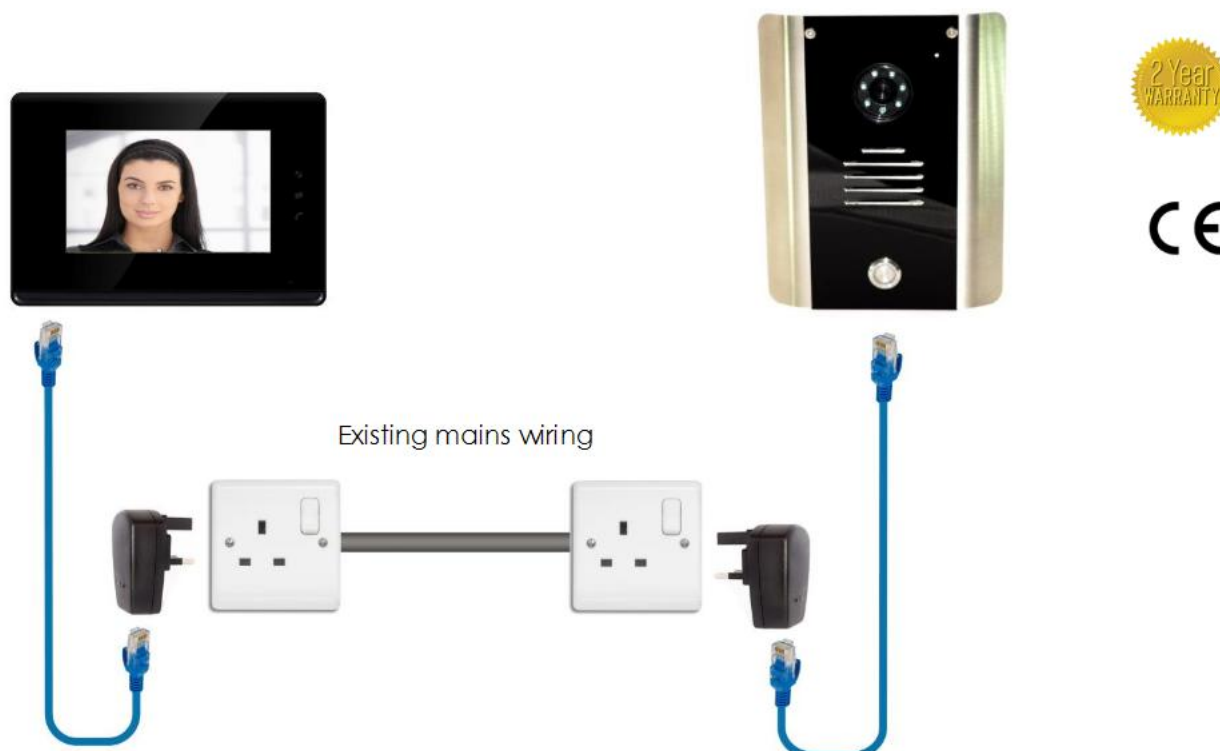

- Digital IP video over mains wiring!
- Up to 500 meters range!
- 64 monitors per door station.
- Wire in panel type mains adaptors or plug type available.
- Wall mount and desk top mounting monitor.
- Door release relay built in.

PowerCom
905-AB
Standard model kit.

PowerCom
905-ABK
Keypad model kit.

Architectural Keypad



- Architectural keypad unit, in matching style to our intercom systems.
- Corrosion proof all stainless steel construction, with modern gloss black centre panel.
- Stylish modern blue illumination lights up the wall or surface on which the unit is mounted.
- Individually illuminated keypad buttons.
- 2 relay outputs.
- 100 codes for output 1, 10 codes for output 2.
- Latching or momentary operation.



ABKP

Technical Specifications

Power	12-24v d.c (adaptor included)	Construction	Stainless steel
Consumption	30mA standby, 115mA both relays on	Dimensions	145mm wide x 144mm tall
IP rating	IP55 weather-proof	Access	Hinged front door.
Outputs	3 - C, N/O and N/C		
Codes	1000 codes output 1, 100 codes output 2, 100 codes output 3.		

CELLCOM GSM-100

GSM Gate Controller



GSM-100



- GSM switch remote control system.
- Ideal for remote control of automatic gates, barriers, doors, central heating systems, home automation, industrial process, intruder alarm dialler and more.
- Can dial out to 3 telephone numbers in the event of the input being triggered.
- 1 x momentary relay output, activated by * (star) key.
- Latching output activated by # (hash) key.
- SMS text control of output.
- 100 telephone number memory for access control of up to 100 users by caller ID automatic number recognition at no call cost to user.
- Password mode access option, with 4 digit code for non stored telephone numbers.
- Control App available from Google Play store for Android, priced £5.51.

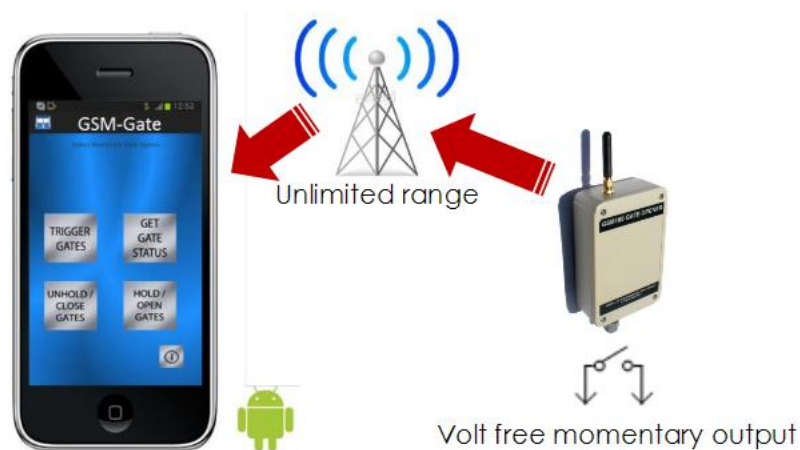

Entrée Phone 302

Wired Intercom System



- Wired audio intercom system.
- Contemporary modern, stylish handset and door station.
- Door station complete with rear back lighting, giving a super contemporary look.
- Up to 4 handsets per door station.

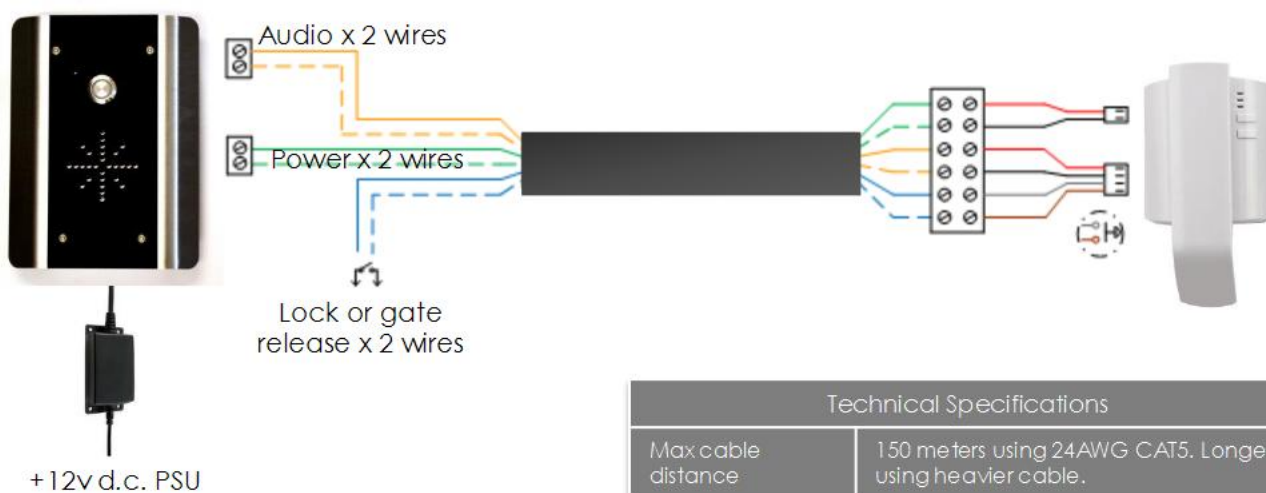

Technical Specifications	
Max cable distance	150 meters using 24AWG CAT5. Longer using heavier cable.
Max handsets	3 per system.
IP rating	IP55
Wiring	2 audio, 2 power, 2 lock release



Architectural model

- Curved modern profile.
- Blue back lighting illumination from behind the curved sides.
- Illuminated push button and keypad.
- Surface mount.
- Stainless steel construction.
- Stylish gloss black acrylic trimmed face.
- IP55 weather proof design.

302-AB Standard model

302-ABK Keypad model



Hooded model

- Traditional hooded style.
- Illuminated push button and keypad.
- Surface mount.
- Stainless steel construction.
- Stylish gloss black acrylic trimmed face.
- IP55 weather proof design.

302-HB Standard model

302-HBK Keypad model



Industrial model

- High volume pedestal mount design for noisy areas.
- Hooded design in landscape style.
- Illuminated push button and keypad.
- Surface mount and pedestal mountable.
- Stainless steel construction with lockable front door.
- Stylish gloss black acrylic trimmed face.
- IP55 weather proof design.

302-iB Standard model

302-iBK Keypad model



Flush model

- Flush fitting for a sleek look.
- All stainless steel construction.
- Illuminated push button.
- Stylish gloss black acrylic trimmed front plate.

302-FB Standard model

302-FBK Keypad model



Additional Handsets

- Add up to 3 additional handsets for larger properties.
- Max total handsets per system = 4.
- Complete with charging base, charger, and rechargeable batteries.

302-EH

Panel Dimensions



AB Panel
Height 193mm
Width 145mm
Depth 40mm
ABK Panel
Height 298mm



HB Panel
Height 165mm
Width 98mm
Depth 58mm
HBK Panel
Height 275mm



FB Panel
Height 193mm
Width 122mm
Depth 40mm
FBK Panel
Height 298mm



iB & iBK Panel
Height 140mm
Width 260mm
Depth (top) 104mm
Depth (bottom) 70mm



AB Keypad
Height 144mm
Width 142mm
Depth 40mm



605AB Panel
Height 202mm
Width 160mm
Depth 40mm
605ABK Panel
Height 302mm



AB Panel
(2-8 button)
Height 288mm
Width 168mm
Depth 40mm
ABK Panel
Height 370mm

Part Numbers Explained

A B C - X Y Z

Family or technology group.
E.g. 603 = wireless DECT system.
605 = Video DECT system

K = Keypad model
Blank = no keypad

B = Black trim model.

A = Architectural model.
H = Hooded model.
i = Industrial model.
F = Flush model.

Prices exclude VAT. Specifications, prices and details subject to change without prior notification.

Tel: +44(0)28 8676 3837

mail: orders@aesdistribution.co.uk